

STAN F5 (P=135,79 m²)

ZGRADA "F"
TLOCRT 2. KATA
MJ. 1:100

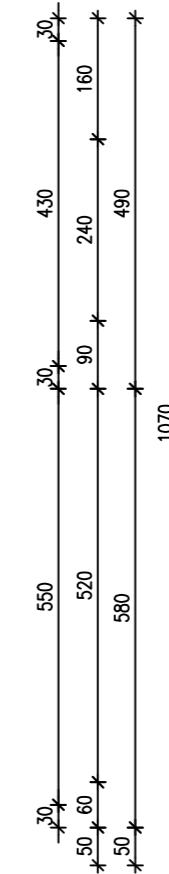

2.KAT - STAN F5				
R.br.	PROSTORIJA	NETTO POVRŠINA (m ²)	KOEF.	PRODAJNA POVRŠINA (m ²)
1	Blagovaonica	15.03	1.0	15.03
2	Dnevni boravak	29.84		29.84
3	Predprostor	4.64		4.64
4	WC	1.05		1.05
5	Soba	8.86		8.86
6	Kupaonica	5.73		5.73
7	Soba	14.54		14.54
8	Kuhinja	7.11		7.11
9	Izba	2.61		2.61
10	Soba	8.68		8.68
	UKUPNO:	98.09		98.09
11	Terasa 1			
	natkriveni dio	28.11	0.50	14.06
	nenatkriveni dio	12.91	0.25	3.23
	ukupno terasa 1:	41.02		17.28
12	Terasa 2			
	natkriveni dio	19.22	0.50	9.61
	nenatkriveni dio	19.22	0.25	4.805
	ukupno terasa 2:	38.44		14.42
	Vanjsko parkirno mjesto PM5	12.0	0.25	3.00
	Vanjsko parkirno mjesto PM6	12.0	0.25	3.00
	STAN F5 UKUPNO:	201.55		135.79

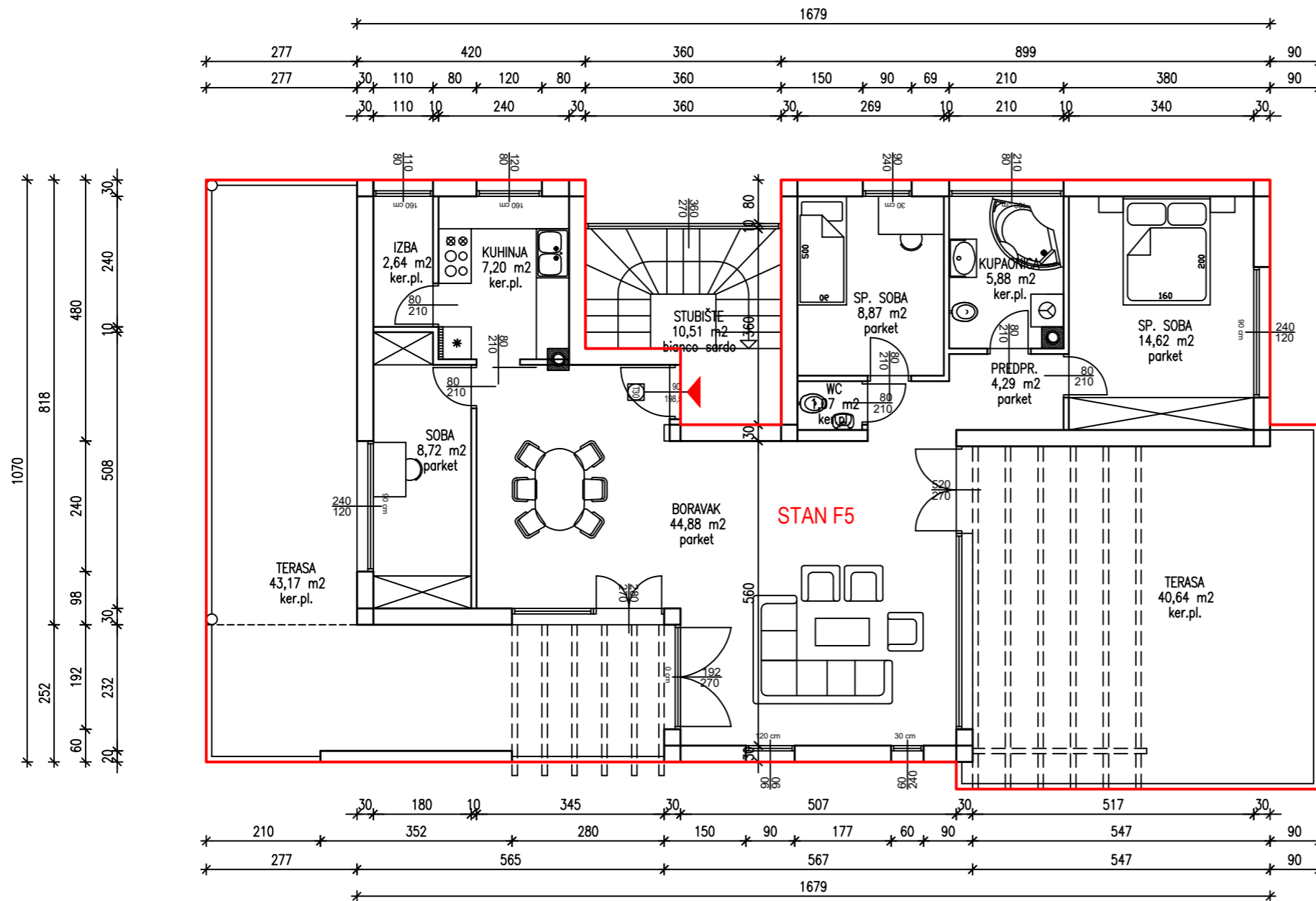
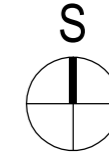